

BEFORE THE ILLINOIS POLLUTION CONTROL BOARD

Mills Farms-New Boston)
(Property Identification Number) PCB No. 21-
01-02-31-100-009) (Tax Certification)
)

NOTICE

PLEASE TAKE NOTICE that I have today filed with the Office of the Clerk of the Pollution Control Board an APPEARANCE and RECOMMENDATION OF THE ILLINOIS ENVIRONMENTAL PROTECTION AGENCY, copies of which are herewith served upon you.

Mills Farm-New Boston
Doug Mills
29007 190th Ave W
Illinois City, Illinois 61259

Don Brown, Clerk
Illinois Pollution Control Board
James R. Thompson Center
100 West Randolph Street, Suite 11-500
Chicago, Illinois 60601

Copies also provided electronically as follows:

Illinois Department of Revenue
via email at REV.PropTaxApp@illinois.gov
101 West Jefferson
P.O. Box 19033
Springfield, Illinois 62794

ILLINOIS ENVIRONMENTAL PROTECTION AGENCY

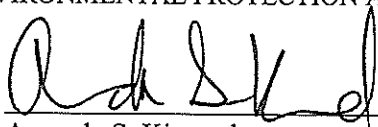
By: 
Amanda S. Kimmel
Assistant Counsel
Division of Legal Counsel

DATED: January 8, 2021

Illinois Environmental Protection Agency
1021 North Grand Avenue East
Post Office Box 19276
Springfield, Illinois 62794-9276
(217) 782-5544

THIS FILING IS SUBMITTED ON RECYCLED PAPER

BEFORE THE ILLINOIS POLLUTION CONTROL BOARD

Mills Farms-New Boston)
(Property Identification Number) PCB No. 21-
01-02-31-100-009) (Tax Certification)
)

A P P E A R A N C E

The undersigned, as one of its attorneys, hereby enters an APPEARANCE on behalf of Respondent,
Illinois Environmental Protection Agency.

ILLINOIS ENVIRONMENTAL PROTECTION AGENCY

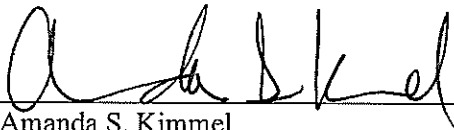
By: 
Amanda S. Kimmel
Assistant Counsel
Division of Legal Counsel

DATED: January 8, 2021

Illinois Environmental Protection Agency
1021 North Grand Avenue East
Post Office Box 19276
Springfield, Illinois 62794-9276
(217)782-5544

THIS FILING IS SUBMITTED ON RECYCLED PAPER

BEFORE THE ILLINOIS POLLUTION CONTROL BOARD

Mills Farms-New Boston)
(Property Identification Number) PCB No. 21-
01-02-31-100-009) (Tax Certification)
)

**RECOMMENDATION OF THE ILLINOIS
ENVIRONMENTAL PROTECTION AGENCY**

The Illinois Environmental Protection Agency ("Illinois EPA") hereby files its Recommendation pursuant to Section 125.204 of the regulations of the Illinois Pollution Control Board ("Board"), 35 Ill. Adm. Code 125.204.

1. On April 3, 2020 and supplemented on May 25, 2020, the Illinois EPA received a request from Mills Farms-New Boston (log number TC-142502, Exhibit A) for an Illinois EPA recommendation regarding the tax certification of water pollution control facilities pursuant to 35 Ill. Adm. Code 125.204.
2. The facility's address is: Mills Farms
1274 44th Street
New Boston, Illinois 61272

The proposed water pollution control facilities in this request are located in the NW ¼ of Section 31, T15N, R5W of the 4th P.M. in Mercer County, at the above street address and consist of the following:

Livestock waste management facilities consisting of one concrete livestock waste pit (approximately 392.33 ft. x 52.16 ft. x 8 ft. deep), ten concrete pump out pits (each approximately 5 ft. x 6 ft. x 8 ft.), and the slotted concrete flooring over the entire area of this manure pit.

These livestock waste management facilities are used to collect, transport, and/or store livestock waste prior to cropland application, and are further described in Exhibit A.

3. Section 11-10 of the Property Tax Code, 35 ILCS 200/11-10 (2018), and Section 125.200(a) of the Board's regulations, 35 Ill. Adm. Code 125.200(a), define "pollution control facilities" as:

any system, method, construction, device or appliance appurtenant thereto or any portion of any building or equipment, that is designed, constructed, installed or operated for the primary purpose of: eliminating, preventing, or reducing air or water pollution ...or treating, pretreating, modifying or disposing of any potential solid, liquid or gaseous pollutant which if released without treatment, pretreatment modification or disposal might be harmful, detrimental or offensive to human, plant or animal life, or to property.

4. In order to receive preferential tax treatment as pursuant to 35 ILCS 200/11-5 (2018), pollution control facilities must be certified as such by the Board, 35 ILCS 200/11-20 (2018) and 35 Ill. Adm. Code 125.200(a).
5. Upon receipt of a tax certification application, the Illinois EPA must file a recommendation on the application with the Board, 35 Ill Adm. Code 125.204(a).
6. Based on the information in the application and the purpose of the facility, it is the Illinois EPA's engineering judgment that the described facilities may be considered "pollution control facilities," pursuant to 35 Ill. Adm. Code 125.200(a), with the primary purpose of eliminating, preventing, or reducing water pollution, or as otherwise provided in 35 Ill. Adm. Code 125.200, and are eligible for tax certification from the Board.

WHEREFORE, the Illinois EPA recommends that the Board issue the requested tax certification.

ILLINOIS ENVIRONMENTAL PROTECTION AGENCY

By: 
Amanda S. Kimmel
Assistant Counsel
Division of Legal Counsel

Dated: January 8, 2021

Illinois Environmental Protection Agency
1021 North Grand Ave. E.
P.O. Box 19276
Springfield, Illinois 62794-9276
217/782-5544



ILLINOIS ENVIRONMENTAL PROTECTION AGENCY

1021 NORTH GRAND AVENUE EAST, P.O. BOX 19276, SPRINGFIELD, ILLINOIS 62794-9276 • (217) 782-3397

JB PRITZKER, GOVERNOR

JOHN J. KIM, DIRECTOR

Memorandum

To: Mike Roubitchek, Division of Legal Counsel

From: Darin E. LeCrone, P.E., Manager, Industrial Unit, Permit Section, Division of Water Pollution Control DEC

Date: OCT 21 2020

Re: Mills Farms - New Boston
Recommendation of Tax Certification
Log No.: TC-142502
BOW ID No.: W1310250005
Property Index Number: 01-02-31-100-009

The Bureau of Water received a request on April 3, 2020 from Mills Farms, having a principal place of business at 29007 190th Ave. W, Illinois City, IL 61259, for an Illinois EPA recommendation regarding the tax certification of water pollution control facilities pursuant to 35 Il. Adm. Code 125.204. We offer the following recommendation.

The water pollution control facilities in this request include the following:

Mills Farms
1274 44th Street
New Boston, IL 61272

NW 1/4 of Section 31, Township 15-North, Range 5-West of the West 4th PM in Mercer County.

Livestock waste management facilities consisting of:

One (1) concrete livestock waste pit measuring 392.33 ft. (length) x 52.16 ft. (width) x 8 ft. (depth) with 10 concrete pump out pits approximately 5 ft. (length) x 6 ft. (width) x 8 ft. (depth) and the slotted concrete flooring over the entire area of this manure pit.

These livestock waste management facilities are used to collect, transport and/or store livestock wastes prior to cropland application.

These facilities are further described in the enclosed applications and supporting documents.

Based on the information included in this submittal, it is our engineering judgment that the above proposed facilities may be considered "Pollution Control Facilities" under 35 IAC 125.200(a), with the primary purpose of eliminating, preventing, or reducing water pollution, or as otherwise provided in this section, and therefore eligible for tax certification from the Illinois Pollution Control Board. The Bureau of Water therefore recommends that the Board issue the requested tax certification for these facilities.

If you have any questions regarding the above, please contact Darren Gove at 217/782-0610.

DRG:TC-142502_Tax Cert Recommendation_03Apr20.docx

4302 N. Main Street, Rockford, IL 61103 (815) 987-7760
595 S. State Street, Elgin, IL 60123 (847) 608-3131
2125 S. First Street, Champaign, IL 61820 (217) 278-5800
2009 Mall Street Collinsville, IL 62234 (618) 346-5120

9511 Harrison Street, Des Plaines, IL 60016 (847) 294-4000
412 SW Washington Street, Suite D, Peoria, IL 61602 (309) 671-3022
2309 W. Main Street, Suite 116, Marion, IL 62959 (618) 993-7200
100 W. Randolph Street, Suite 4-500, Chicago, IL 60601

Page No. 2

Tax Certification Recommendation

Log No. TC-142502

cc: Tax Cert File

cc: Tax Cert File



ILLINOIS ENVIRONMENTAL PROTECTION AGENCY

1021 NORTH GRAND AVENUE EAST, P.O. BOX 19276, SPRINGFIELD, ILLINOIS 62794-9276 • (217) 782-3397

JB PRITZKER, GOVERNOR

JOHN J. KIM, DIRECTOR

Memorandum

To: Mike Roubitchek, Division of Legal Counsel

From: Darin E. LeCrone, P.E., Manager, Industrial Unit, Permit Section, Division of Water Pollution Control DEC

Date: OCT 21 2020

Re: Mills Farms - New Boston
Recommendation of Tax Certification
Log No.: TC-142502
BOW ID No.: W1310250005
Property Index Number: 01-02-31-100-009

The Bureau of Water received a request on April 3, 2020 from Mills Farms, having a principal place of business at 29007 190th Ave. W, Illinois City, IL 61259, for an Illinois EPA recommendation regarding the tax certification of water pollution control facilities pursuant to 35 Il. Adm. Code 125.204. We offer the following recommendation.

The water pollution control facilities in this request include the following:

Mills Farms
1274 44th Street
New Boston, IL 61272

NW 1/4 of Section 31, Township 15-North, Range 5-West of the West 4th PM in Mercer County.

Livestock waste management facilities consisting of:

One (1) concrete livestock waste pit measuring 392.33 ft. (length) x 52.16 ft. (width) x 8 ft. (depth) with 10 concrete pump out pits approximately 5 ft. (length) x 6 ft. (width) x 8 ft. (depth) and the slotted concrete flooring over the entire area of this manure pit.

These livestock waste management facilities are used to collect, transport and/or store livestock wastes prior to cropland application.

These facilities are further described in the enclosed applications and supporting documents.

Based on the information included in this submittal, it is our engineering judgment that the above proposed facilities may be considered "Pollution Control Facilities" under 35 IAC 125.200(a), with the primary purpose of eliminating, preventing, or reducing water pollution, or as otherwise provided in this section, and therefore eligible for tax certification from the Illinois Pollution Control Board. The Bureau of Water therefore recommends that the Board issue the requested tax certification for these facilities.

If you have any questions regarding the above, please contact Darren Gove at 217/782-0610.

DRG:TC-142502_Tax Cert Recommendation_03Apr20.docx

4302 N. Main Street, Rockford, IL 61103 (815) 987-7760
595 S. State Street, Elgin, IL 60123 (847) 608-3131
2125 S. First Street, Champaign, IL 61820 (217) 278-5800
2009 Mall Street Collinsville, IL 62234 (618) 346-5120

9511 Harrison Street, Des Plaines, IL 60016 (847) 294-4000
412 SW Washington Street, Suite D, Peoria, IL 61602 (309) 671-3022
2309 W. Main Street, Suite 116, Marion, IL 62959 (618) 993-7200
100 W. Randolph Street, Suite 4-500, Chicago, IL 60601

May 11, 2020 - sent email and called left message with Douglas Mills to provide necessary information
May 25, 2020 - received email from DM with additional information required

Nothing follows – DRG - (July 27, 2020)

Electronic Filing: Received, Clerk's Office 1/8/2021 **PCB 2021-051**
Illinois EPA - Bureau of Water - Division of Pollution Control
Title 35 Subtitle A Part 125 Tax Certifications
Illinois EPA Review Notes for:

Agency Recommendation of Pollution Control Facilities.

BOW ID #: W1310250005

Project Name: Mills Farms

Date application received: 4/3/2020

Reviewer: DRG

Log number: TC-142502

Legal Description:
NW 1/4 of Section 31 Twp: 15-North Range: 5-
West PM: West 4th

County: Mercer

Facility Contact:

Phone: _

Pollution Control Facility Type:
Swine Livestock Waste Management Facility

Property ID: 01-02-31-100-009

Applicant: Mills Farms
29007 190th Ave. W
Illinois City, IL 61259

Facility: Mills Farms
1274 44th Street
New Boston, IL 61272

Date Control Devices installed: 12/12/2019

Application Signature by: Douglas Mills

Title: Owner

Contents of Application: New application form, facility diagram, process flow diagram, email dtd 5/25 with new drawn diagram and information.

Is there a pollutant control flow diagram? Yes

Is there sufficient diagrams showing the pollution control facilities? Yes

This facility generates the following pollutants and prevents their discharge as indicated:
Livestock waste is collected and land applied to cropland.

Physical description of pollution control facilities that ARE recommended:

Livestock waste management facilities consisting of:

One (1) concrete livestock waste pit measuring 392.33 ft. (length) x 52.16 ft. (width) x 8 ft. (depth) with 10 concrete pump out pits approximately 5 ft. (length) x 6 ft. (width) x 8 ft. (depth) and the slotted concrete flooring over the entire area of this manure pit.

These livestock waste management facilities are used to collect, transport and/or store livestock wastes prior to cropland application.

Click or tap here to enter text.

Notes:

Gove, Darren

From: Doug Mills <doug mills93@gmail.com>
Sent: Monday, May 25, 2020 11:44 AM
To: Gove, Darren; Megan Talley
Subject: Re: [External] Re: Mills Farms Tax Certification application IL EPA log no TC-142502
Attachments: mills diagram0001.pdf

Darren,

Thank you for sending the application. Here are the answers I believe you were needing along with a new diagram. Would you like me to send these in the mail as well or will this email suffice? Please give Megan a call if you have any questions.

Facility Location: NW quarter of section 31, Township 15-N, Range 5-W
Property Index Number: 01-02-31-100-009

Thanks,
Megan Mills
319-899-6138

Douglas Mills
Mills Farms Manager
(563) 260-5691

On Wed, May 20, 2020 at 12:40 PM Gove, Darren <Darren.Gove@illinois.gov> wrote:

Attached is your application. I think your diagram is fine it just needs to be readable. Our records digitization process would render the version you gave us as a black blob, much worse than the copy I am sending you. If you don't have a copy of the diagram to send, you can carefully draw your facility provided it shows the feature you are requesting and pertinent dimensions. Thanks

Darren Gove

Permit Section, DWPC

BOW, Illinois EPA

217 782-3362

From: Doug Mills <doug mills93@gmail.com>
Sent: Wednesday, May 20, 2020 11:47 AM
To: Gove, Darren <Darren.Gove@Illinois.gov>
Subject: [External] Re: Mills Farms Tax Certification application IL EPA log no TC-142502

Darren,

Can you please send a PDF version of the application or point me in the direction of where I can find one online? I sent the only copy I had when I submitted it. Also, is there an example of what you would need for the diagram?

Thanks,

Douglas Mills

Mills Farms Manager

(563) 260-5691

On Mon, May 11, 2020 at 8:04 AM Gove, Darren <Darren.Gove@illinois.gov> wrote:

Good morning,

I am processing your request for tax certification of pollution control facilities for the subject operation. Based on my review of the application material, the request is deficient for the following reasons:

1. The application form does not disclose the PLSS Section number on which the requested facility resides (See Section II. Facility Information)
2. The application form does not disclose the Property index number (See Section II. Facility Information)
3. The diagram showing the features and dimensions of the pollution control facility is not legible enough for use and public records.

Electronic Filing: Received, Clerk's Office 1/8/2021 **PCB 2021-051**

Please provide a written response to the above items to address these deficiencies in no more than 30 days. I will call the phone number indicated to provide you notice of this email. If a response is not received within 30 days the Agency will consider the request withdrawn.

Kindest regards,

Darren Gove

Permit Section, DWPC

BOW, Illinois EPA

217 782-3362

State of Illinois - CONFIDENTIALITY NOTICE: The information contained in this communication is confidential, may be attorney-client privileged or attorney work product, may constitute inside information or internal deliberative staff communication, and is intended only for the use of the addressee. Unauthorized use, disclosure or copying of this communication or any part thereof is strictly prohibited and may be unlawful. If you have received this communication in error, please notify the sender immediately by return e-mail and destroy this communication and all copies thereof, including all attachments. Receipt by an unintended recipient does not waive attorney-client privilege, attorney work product privilege, or any other exemption from disclosure.

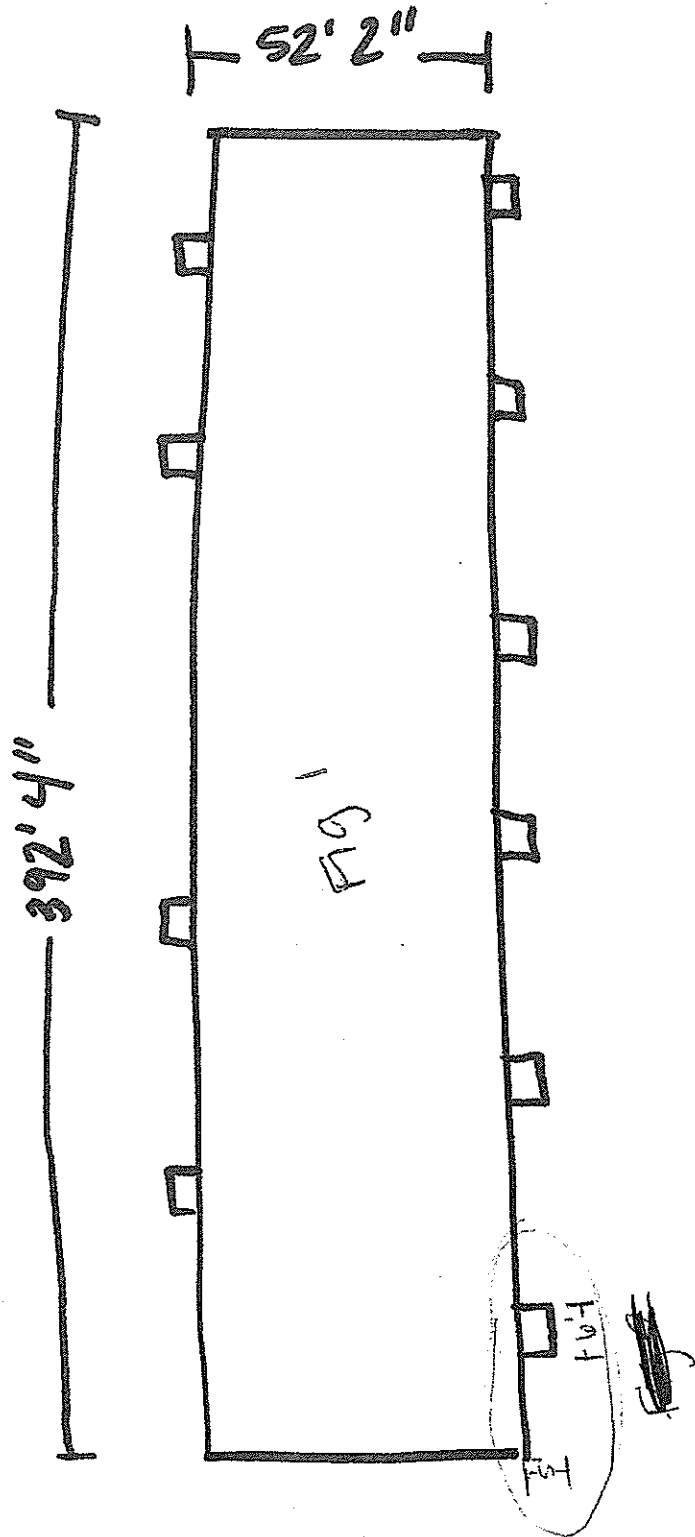

Doug Mills Hog Barn Diagram

Gove, Darren

From: Gove, Darren
Sent: Monday, May 11, 2020 8:04 AM
To: dougmills93@gmail.com
Subject: Mills Farms Tax Certification application IL EPA log no TC-142502

Good morning,

I am processing your request for tax certification of pollution control facilities for the subject operation. Based on my review of the application material, the request is deficient for the following reasons:

1. The application form does not disclose the PLSS Section number on which the requested facility resides (See Section II. Facility Information)
2. The application form does not disclose the Property index number (See Section II. Facility Information)
3. The diagram showing the features and dimensions of the pollution control facility is not legible enough for use and public records.

Please provide a written response to the above items to address these deficiencies in no more than 30 days. I will call the phone number indicated to provide you notice of this email. If a response is not received within 30 days the Agency will consider the request withdrawn.

Kindest regards,

Darren Gove
Permit Section, DWPC
BOW, Illinois EPA
217 782-3362

Illinois Environmental Protection Agency

1021 North Grand Avenue East • P.O. Box 19276 • Springfield • Illinois • 62794-9276 • (217) 782-3397

Application for Certification (Property Tax Treatment) Pollution Control Facility

RECEIVED
APR 06 2020
IEPA
BOW/WPC/PERMIT SECTION

W1310250005

| FOR AGENCY USE ONLY | |
|-----------------------------|-------------------|
| File Number: _____ | Date Rec'd: _____ |
| Certification Number: _____ | Date: _____ |

Facility Type (check one): Air Water

This form is to be used for any application for certification of property tax treatment for a pollution control facility for air or water from the Illinois EPA. Separate applications must be completed for each control facility claimed. Do not mix types (e.g., air and water operations are related, file two applications).

If attachments are needed, record them consecutively on an index sheet.

You may complete this form online, save a copy locally, print, sign and submit it to:

Illinois EPA
Attention: Ray E. Pilapil, Permit Section
Division of Air Pollution Control
1021 North Grand Avenue East, P.O. Box 19276
Springfield, IL 62794-9276

Illinois EPA
Attention: Al Keller, Permit Section
Division of Water Pollution Control
1021 North Grand Avenue East, P.O. Box 19276
Springfield, IL 62794-9276

RECEIVED
APR 03 2020
IEPA/CAS

I. Applicant Information:

| | |
|---|---|
| Company Name: <u>MILLS FARMS</u> | Person to Contact for Additional Details: <u>DOUG MILLS</u> |
| Person Authorized to Receive Certification: <u>DOUG MILLS</u> | Street Address: <u>29007 190th Ave W</u> |
| Street Address: <u>29007 190th Ave W</u> | City: <u>ILLINOIS CITY</u> State: <u>IL</u> |
| City: <u>ILLINOIS CITY</u> State: <u>IL</u> | Zip: <u>61259</u> Phone: <u>5632405691</u> |
| Zip: <u>61259</u> Phone: <u>5632405691</u> | Email Address: <u>dougmills93@gmail.com</u> |
| Email Address: <u>dougmills93@gmail.com</u> | |

IEPA
BOW/WPC/PERMIT SECTION

II. Facility Information:

Facility Location: Quarter Section: NW Township: 15-N Range: S-W
Municipality: _____ Township: _____

Note: A plat map location is requested for facilities located outside of municipal boundaries.

Address: 1274 44th St City: New Boston
State: IL Zip Code: 61272 County: Mercer Book Number: _____

Property Index Number: _____

Note: The Property Index Number is the numerical reference used to identify a parcel of real property for assessment and taxation purposes.

Manufacturing Operations Information:

Nature of Operations Conducted at the Above Location:

Swine Production

Permit Information:

| | |
|---------------------------------------|-------------------------------------|
| WPC Construction Permit Number: _____ | Date Issued: _____ |
| NPDES Permit Number: _____ | Date Issued: _____ Exp. Date: _____ |
| APC Construction Permit Number: _____ | Date Issued: _____ |
| APC Operating Permit Number: _____ | Date Issued: _____ Exp. Date: _____ |

Note: Submit copies of all relevant permits issued by local pollution control agencies. (e.g. MSD Construction Permit)

This Agency is authorized to request this information under 415 ILCS 5/4(b)(2012). Disclosure of this information is voluntary and no penalties will result from the failure to provide the information. However, the absence of the information could prevent your application from being processed or could result in denial of your application.

Manufacturing Process Information:

Please provide information on the manufacturing process and materials on which pollution control facility is used, including each major piece of equipment associated with the pollution control facility (or low sulfur dioxide emission coal fueled device).
Description of the Process:

Materials Used in the Process:

Pollution Control Facility Information:

Please provide a narrative description of the pollution control facility (or low sulfur dioxide emission coal fueled device), and an explanation of why its primary purpose is to eliminate, prevent or reduce pollution. State the type of control facility, as well as a narrative description and a process flow diagram describing the pollution control facility. Include an average analysis of the influent and effluent of the control facility stating the collection efficiency, if applicable.

Describe the Pollution Control Facility (or Low Sulfur Dioxide Emission Coal Fueled Device): - 392.33 x 52.16

one concrete manure pit (391' x 50' x 8' deep) with concrete pump-out pits (each 5' x 6' x 8' deep) and the slotted concrete portion of the floor over the manure pit. see attached drawing.

Describe the Primary Purpose of the Pollution Control Facility (or Low Sulfur Dioxide Emission Coal Fueled Device):

contain manure and protect the water supply.

Identify the statute or regulation (federal or state), or local ordinance, if any, requiring the installation of the subject pollution control facility (or low sulfur dioxide emission coal fueled device).

Nature of Contaminants or Pollutants:

List air contaminants or water pollution substances released as effluents to the manufacturing processes. Also list the final disposal of any contaminants removed from the manufacturing processes.

| Contaminant or Pollutant | Material Retained, Captured or Recovered | |
|--------------------------|--|----------------------|
| | Description | Disposal or Use |
| Swine Manure | Swine Manure | Fertilizer for crops |
| | | |
| | | |
| | | |

Note: Contaminant or pollutant means that which is removed from the process by the pollution control facility.

Point(s) of Waste Water Discharge:

Identify the location of the discharge to the receiving stream. This will typically refer to a source of water pollution but can include water-carried wastes from air pollution control facilities.

Plans and Specifications Attached Yes No

Submit Drawings, which clearly show:

- (a) Point(s) of discharge to receiving stream; and
- (b) Sewers and process piping to and from the control facility.

Are contaminants (or residues) collected by the control facility? Yes No

Note: If the collected contaminants are disposed of other than as wastes, state the disposition of the materials, and the value dollars reclaimed by the sale or reuse of the collected substances. State the cost of reclamation and related expense.

Project Status:

Date Installation Completed: 12/12/2019

Provide the date the pollution control facility was first placed into service and operated. If not, explain.

| |
|----------|
| 12/12/19 |
|----------|

Status of installation on date of application:

| |
|--|
| |
|--|

III. Verification and Signature:

The following information is submitted in accordance with the Illinois Property Tax Code, as amended, and to the best of my knowledge is true and correct.

Any person who knowingly makes a false, fictitious, or fraudulent material statement, orally or in writing, to the Illinois EPA commits a Class 4 felony. A second or subsequent offense after conviction is a Class 3 felony. (415 ILCS 5/44(h))

Douglas Mills
Printed Name:

2/8/2020
Title:

For incorporated entities, signature should be from an authorized corporate representative.

Signature:

2/8/2020
Date:

Narrative Description of Pollution Control Facility

One wean-to-finish hog building measuring 391' x 50' x 8' deep pit. Building consists of concrete foundation and concrete slatted floors over 100% of the 391' x 50' x 8' deep pit. Finished grade around building prevents fresh water from running into pits. Manure storage is adequate to contain 14 months of manure production which will safely protect the well and nearby crop from contamination. We do not have an inspection port for checking manure leakage into groundwater which was NRCS approved. Manure from the pits will be pumped annually and applied through sub-surface injection at an appropriate agronomic rate to the nearby cropland.

Diagram Description (diagram found on next page):

- Grass vegetation surrounds building and field road
- 10 concrete pump outs measuring 5' x 6' x 8' deep protrude on both sides of the building foundation. Concrete pump outs indicate where the manure will be removed annually and then applied at an appropriate agronomic rate to neighboring cropland. Fig. 1
- Slatted concrete flooring over liquid manure pit. Fig. 2

Manure Generation Flow Diagram

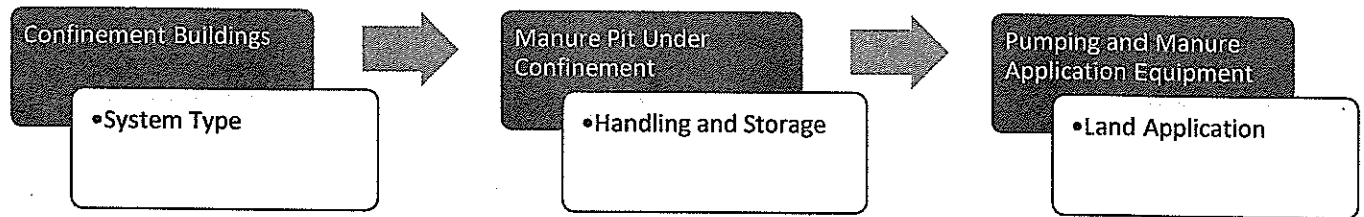

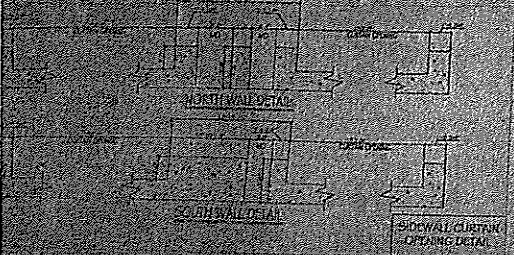
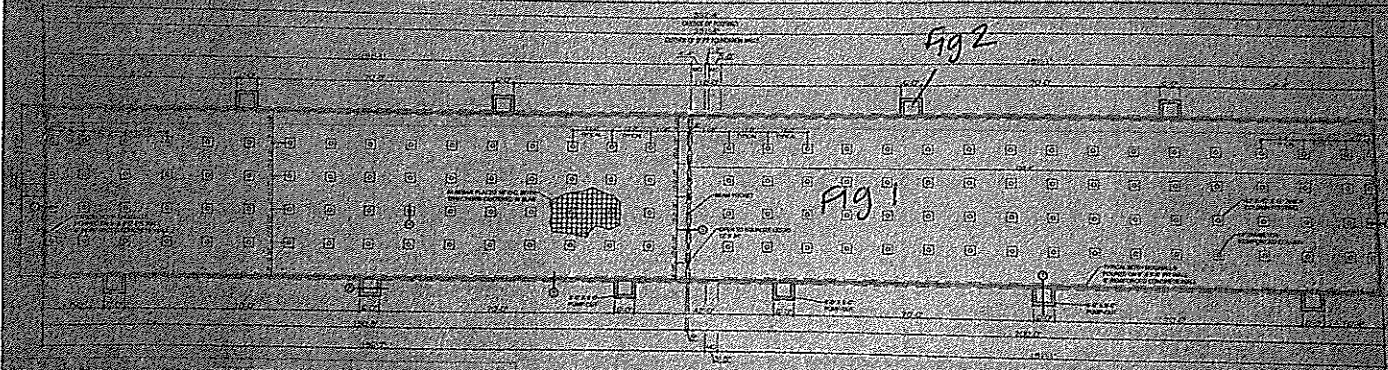

THIS IS TO CERTIFY THAT THE DESIGN OF THE PLANS, SPECIFICATIONS, AND SCHEDULES FOR THE PROJECT OF THE STATE OF ILLINOIS, HAS BEEN REVIEWED AND APPROVED BY ME AS A PROFESSIONAL ENGINEER IN THE STATE OF ILLINOIS. I AM NOT PROVIDING ANY GUARANTEE OR WARRANTY FOR THE DESIGN OR CONSTRUCTION OF THE PROJECT. I AM NOT PROVIDING ANY GUARANTEE OR WARRANTY FOR THE DESIGN OR CONSTRUCTION OF THE PROJECT. I AM NOT PROVIDING ANY GUARANTEE OR WARRANTY FOR THE DESIGN OR CONSTRUCTION OF THE PROJECT.

TO THE BEST OF MY PROFESSIONAL KNOWLEDGE, COMPETENCY, AND SKILL, THE DESIGN AND CONSTRUCTION OF THE PROJECT WILL BE IN ACCORDANCE WITH THE REQUIREMENTS OF THE ILLINOIS PROFESSIONAL ENGINEERING ACT AND THE ILLINOIS PROFESSIONAL ENGINEERING BOARD. I AM NOT PROVIDING ANY GUARANTEE OR WARRANTY FOR THE DESIGN OR CONSTRUCTION OF THE PROJECT.

Michael R. Leslie
MICHAEL R. LESLIE, P.E., C.E.

STATE OF ILLINOIS)
)
COUNTY OF SANGAMON)
)
)

CERTIFICATE OF SERVICE

I, the undersigned attorney at law, hereby certify that I have served on the date of January 8, 2021, the attached **NOTICE, APPEARANCE and RECOMMENDATION OF THE ILLINOIS ENVIRONMENTAL PROTECTION AGENCY**, upon the following persons by causing to be mailed a true copy thereof in an envelope duly addressed, bearing proper first class postage, and deposited in the United States mail at Springfield, Illinois:

Mills Farm-New Boston
Doug Mills
29007 190th Ave W
Illinois City, Illinois 61259

Copies also provided electronically as follows:

Illinois Department of Revenue
via email at REV.PropTaxApp@illinois.gov
101 West Jefferson
P.O. Box 19033
Springfield, Illinois 62794

[Electronic Filing]

Clerk
Illinois Pollution Control Board
James R. Thompson Center
100 West Randolph Street, Suite. 11-500
Chicago, Illinois 60601

ILLINOIS ENVIRONMENTAL PROTECTION AGENCY

/s/ Amanda S. Kimmel
Assistant Counsel
Division of Legal Counsel
1021 North Grand Avenue East
P.O. Box 19276
Springfield, Illinois 62794-9276
217.782.5544
217.782.9143 (TDD)

THIS FILING IS SUBMITTED ON RECYCLED PAPER